

MLS17813N

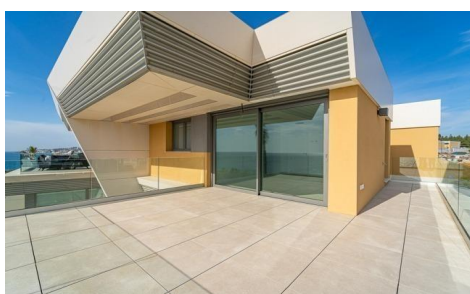

FANTASTIC FINISHED HOUSE, WALKING DISTANCE TO BEACH



4



4



189m²



N/A



*** FANTASTIC HOUSES READY TO MOVE IN. NEW CONSTRUCTION COMPLETED, WALKING DISTANCE TO THE BEACH, GOLF CLUB AND LOCAL AMENITIES. SPECTACULAR SEA VIEWS !!! . (*** SEE FLOORPLAN BETWEEN THE PHOTOS ***). Brand new semi-detached villa—designed by the prestigious Morph Studio Architects. — Spacious 4 Bedroom, 3.5 Bathroom, Front line, south/south-east facing. 255sqm South facing sunny garden with automatic/timer watering system. Possible to add private pool. —Kitchen fitted with all Bosch appliances. Eco Aerothermia system for air-conditioning, heating and hot water. Bosch Washer and dryer included. —All windows and doors by Strugal. — GROUND FLOOR:—Light and